

ENGINEERING & COMPUTER SCIENCE LIBRARY UPDATE!

- Reno
- Downsvievw
- Beyond spaces and collections
- Thank you and Introduction

THE RENO

Someday it will end...

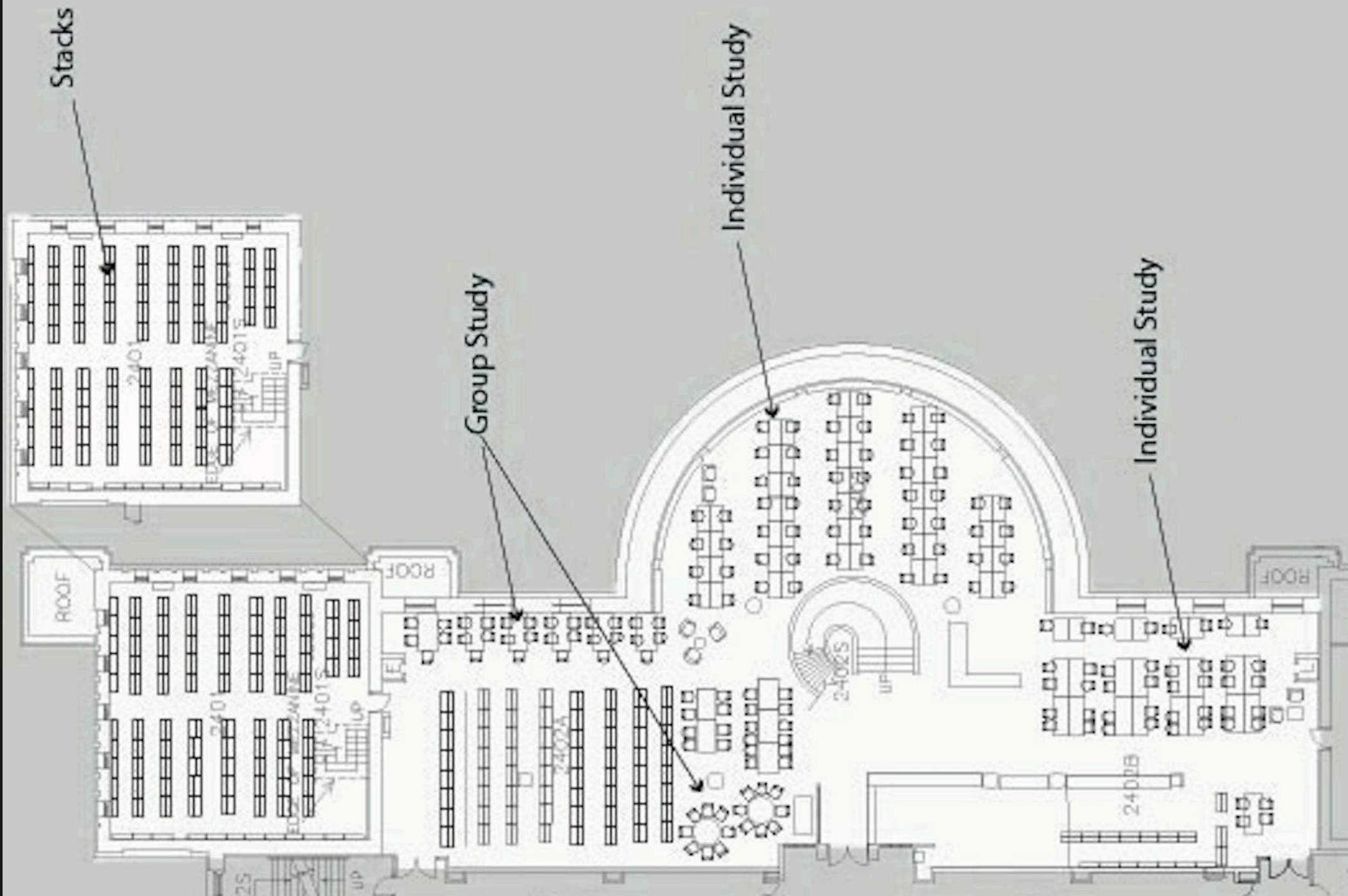

Total Capacity 2nd Floor - User Accessible

- 876 LF
- 324 LF
- 443 LF (built-in)
- 1643 LF - Total**

- 486 LF - Not User Accessible

Existing built-in shelving ~ 443 LF

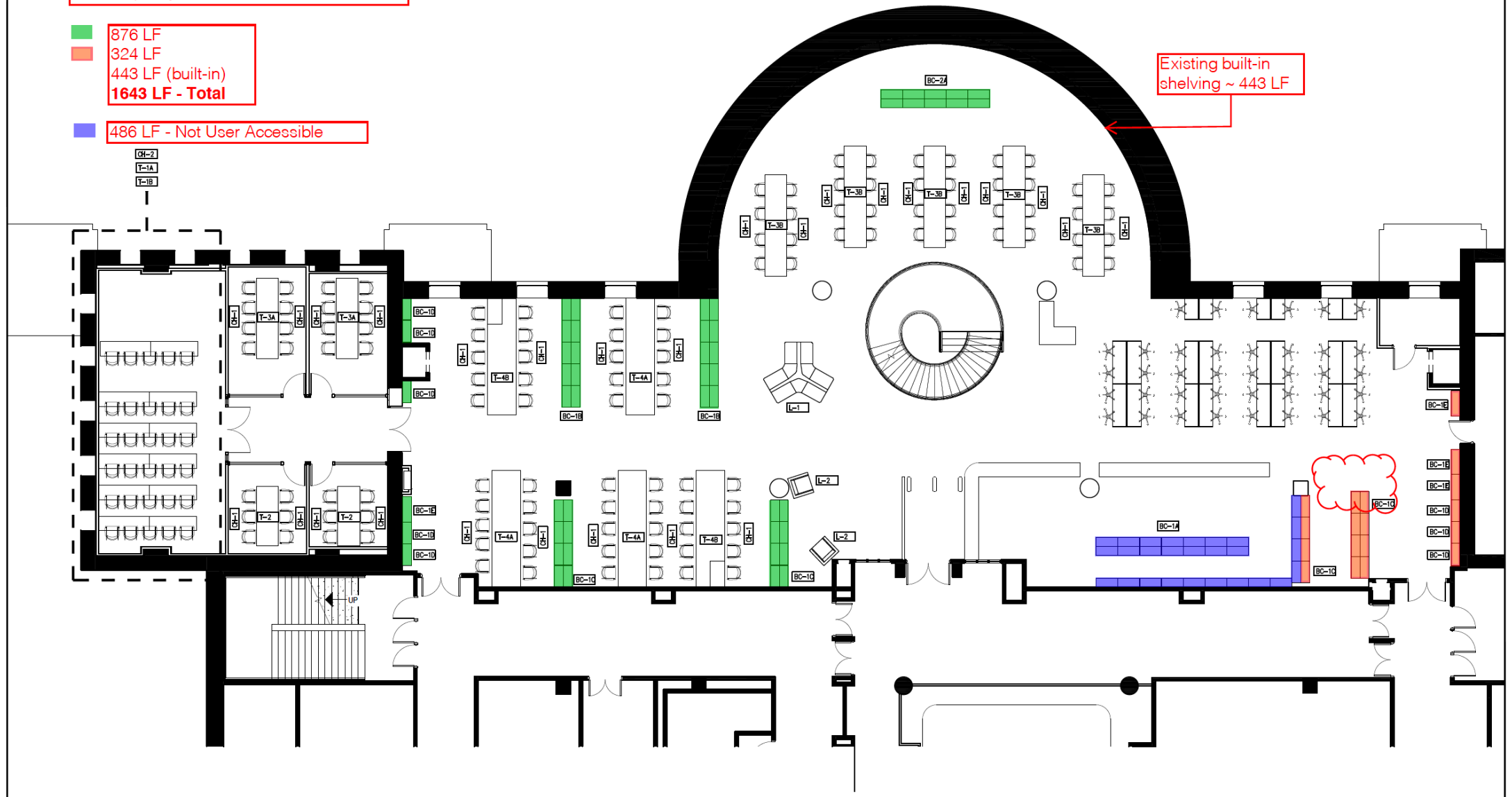



Journals: Focus – Z







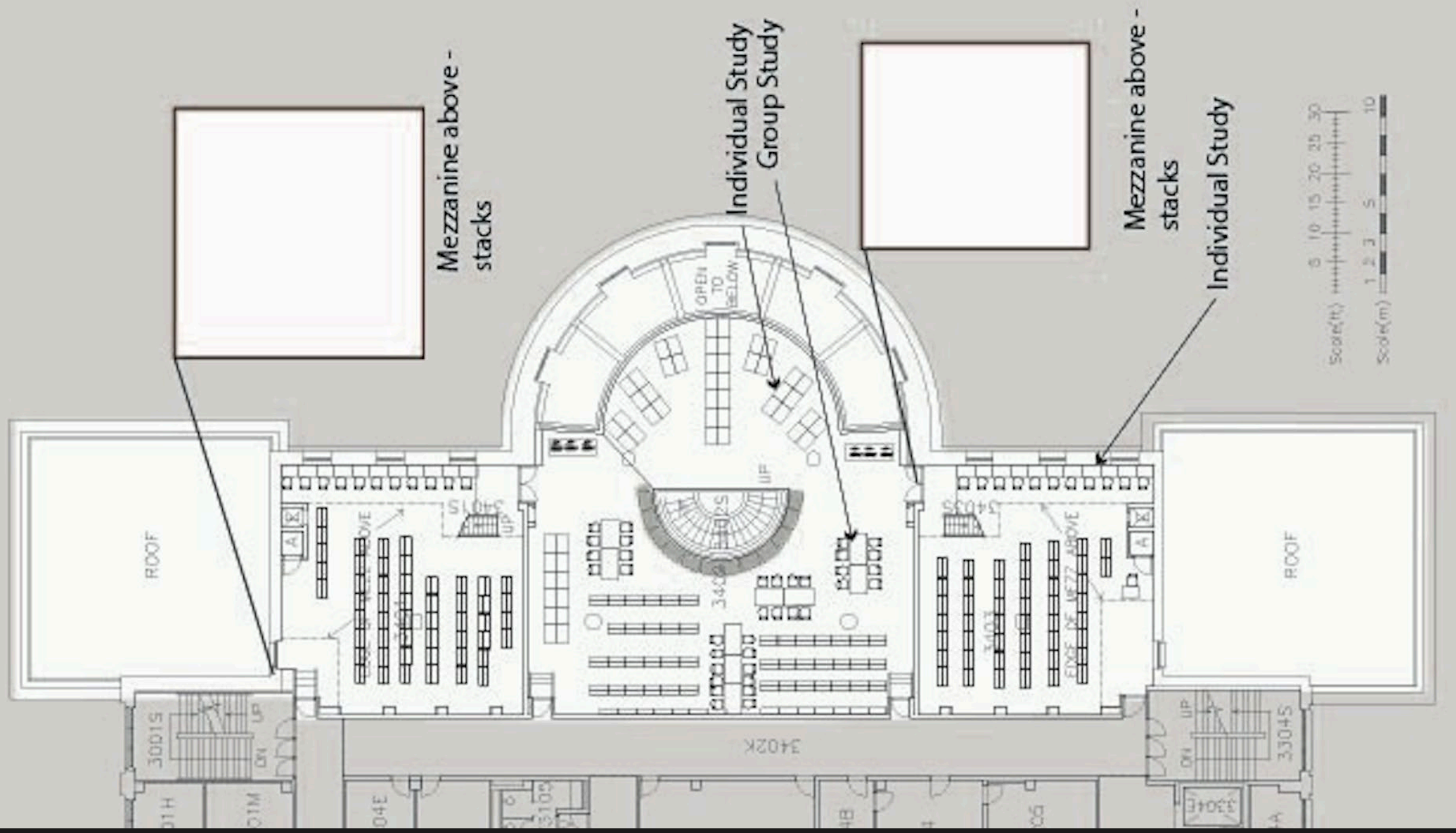

Mezzanine above -
stacks

Individual Study
Group Study

Mezzanine above -
stacks

Individual Study

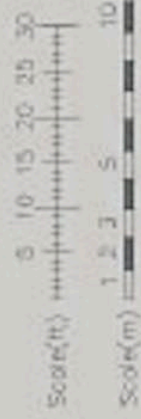

Total Capacity 3rd Floor - User Accessible

- 4526 LF (existing)
- 576 LF
- 360 LF
- 5462 LF - Total**

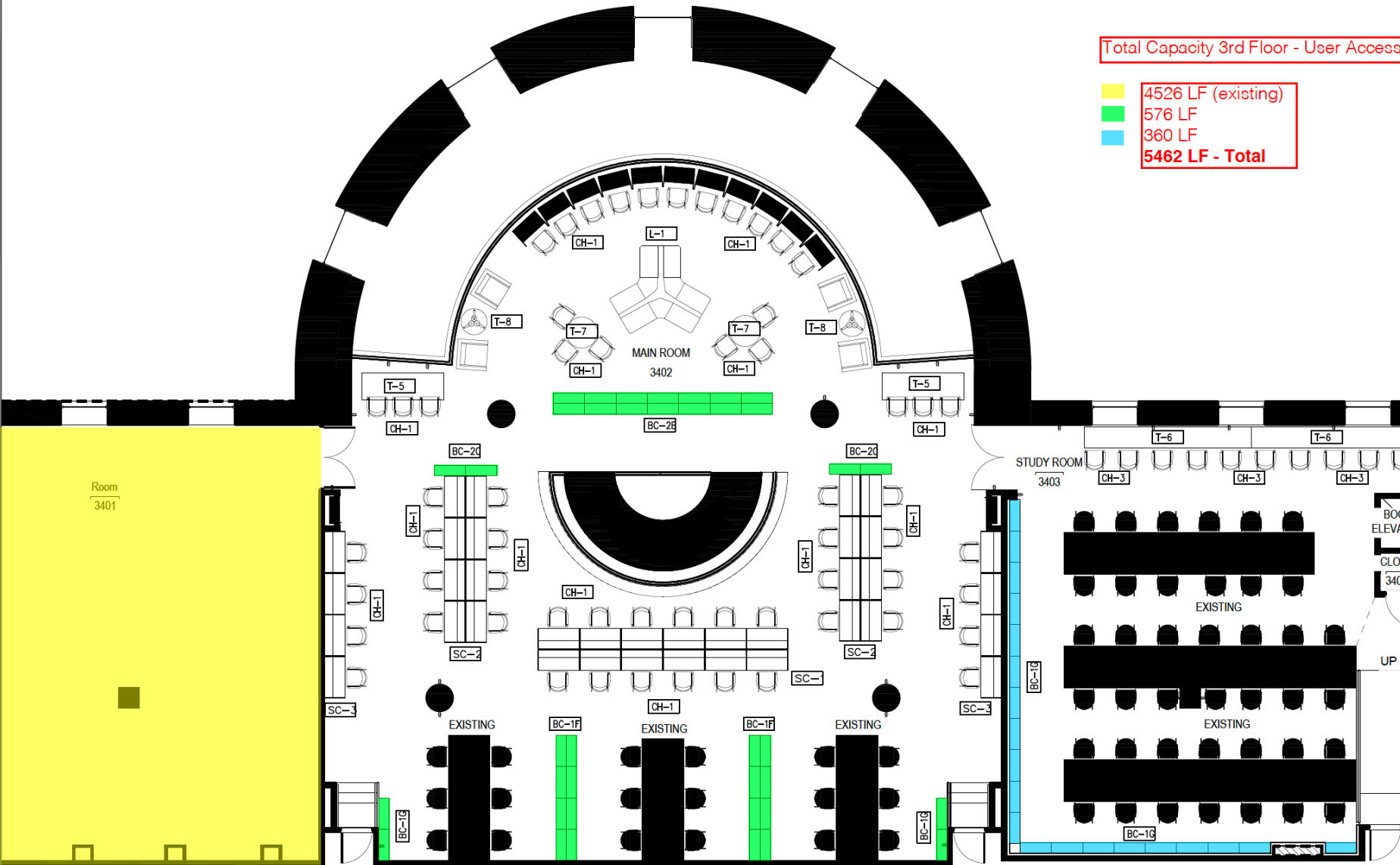







DOWNSVIEW

Where the stuff goes...



NOT JUST COLLECTIONS AND SPACES

A few “subtle” highlights

Open Access - Tri-agency OA policy; Transformational Agreements

Research Data Management (RDM), Data Management Plan (DMP), Data Deposit -
Tri-agency RDM policy

Open Science - 5-part panel series, *Following the Roadmap for Research*:
<https://cris.utoronto.ca/related/open-science-nov2021/>

THANK YOU!

It has been a pleasure...

Hello and welcome!

angela.henshilwood@utoronto.ca

